

West 1/4 Corner
Section 7-3-17.

West 271.00'

South 1031.73'

West line of the Southwest 1/4 of Section 7-3-17.

North 1028.00'

West 86.00'

North 460.00'

East 121.00'

North 120.00'

East 174.28'

United States Highway 12 & State Trunk Highway 67

(6714.021)

Arc=456.97'

CHB=S 7°48'14" E
C=456.58
R=1687.30
I=15°25'33"

Lot 1
C.S.M. 1758
10.213 Acres
444,864 Sq.Ft.

Building
Under Construction
See Detail

Southwest Corner
Section 7-3-17.

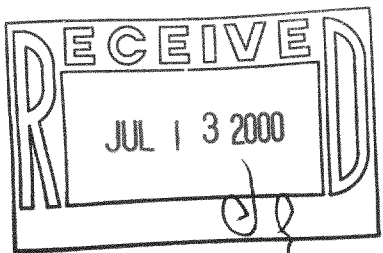
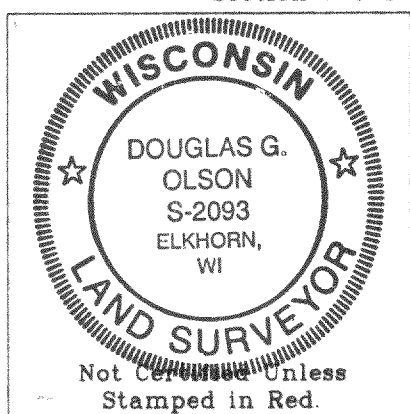

Notes:

1. This survey plat is not certified unless signed and sealed in red ink.
2. This survey plat is subject to Wisconsin lien laws. This Plat of Survey is the notice of intent to file lien. Lien waiver required.

Property Exhibit

of

Lot 1 of Certified Survey Map No. 1758,

recorded in Vol. 8 of Certified Survey Maps of Walworth County on Page 185, located in the Southwest 1/4 of Section 7, Town 3 North, Range 17 East, Town of LaFayette, Walworth County, Wisconsin.

Prepared for: **Southern Lakes Evangelical Free Church**
20 1/2 East Walworth Street
Elkhorn, Wisconsin. 53121

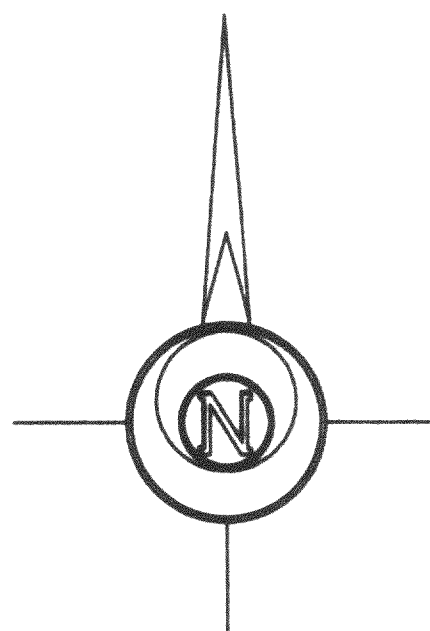

Bearings referenced to Certified
Survey Map No. 1758.

Detail

1" = 30'

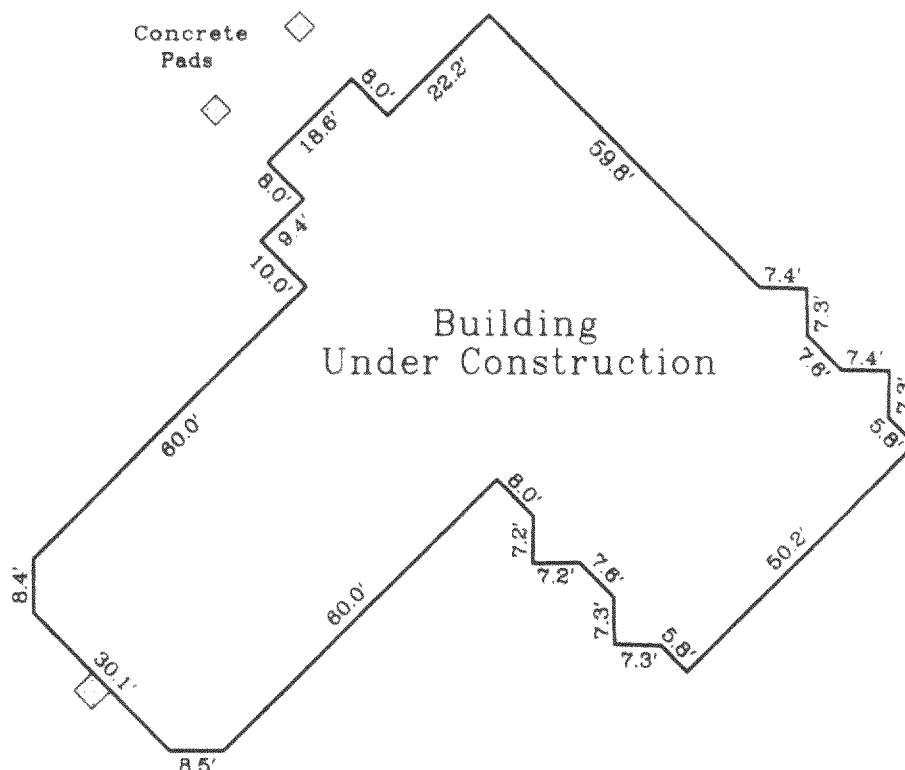

Copyright © 1999 by Jensen & Olson Land Surveying, LLC.

All rights reserved. No part of this survey plat may be reproduced or transmitted in any form by any means - graphic, electronic, or mechanical, including photocopying, tracing, or information storage and retrieval systems - without permission in writing from Douglas G. Olson, Jensen & Olson Land Surveying, LLC.

I, Douglas G. Olson, Wisconsin Registered Land Surveyor, do hereby certify that this survey was performed by me or under my direction in full compliance with owners' agents' instructions and Chapter A-E 7 of the Wisconsin Administrative Code Minimum Standards for Property Surveys, and that this map is an accurate representation thereof to the best of my knowledge and belief.

Date: 11-19-99

Douglas G. Olson
Wisconsin Registered Land Surveyor - 2093

1999.129

Sheet 1 of 1 Sheets

Legend

- Found Iron Pipe
- () Recorded Information
- Concrete Cover
- PVC Pipe

Job Reference Number

1999.129



Jensen & Olson Land Surveying, LLC

45 South Wisconsin Street P.O. Box 322
Elkhorn, Wisconsin. 53121
Telephone (262) 723-3434
Facsimile (262) 723-8044

Scale in Feet

1" = 100'

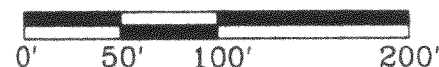

Survey Date: Nov. 19, 1999.

Revisions:

KA-1758-1

317-493